

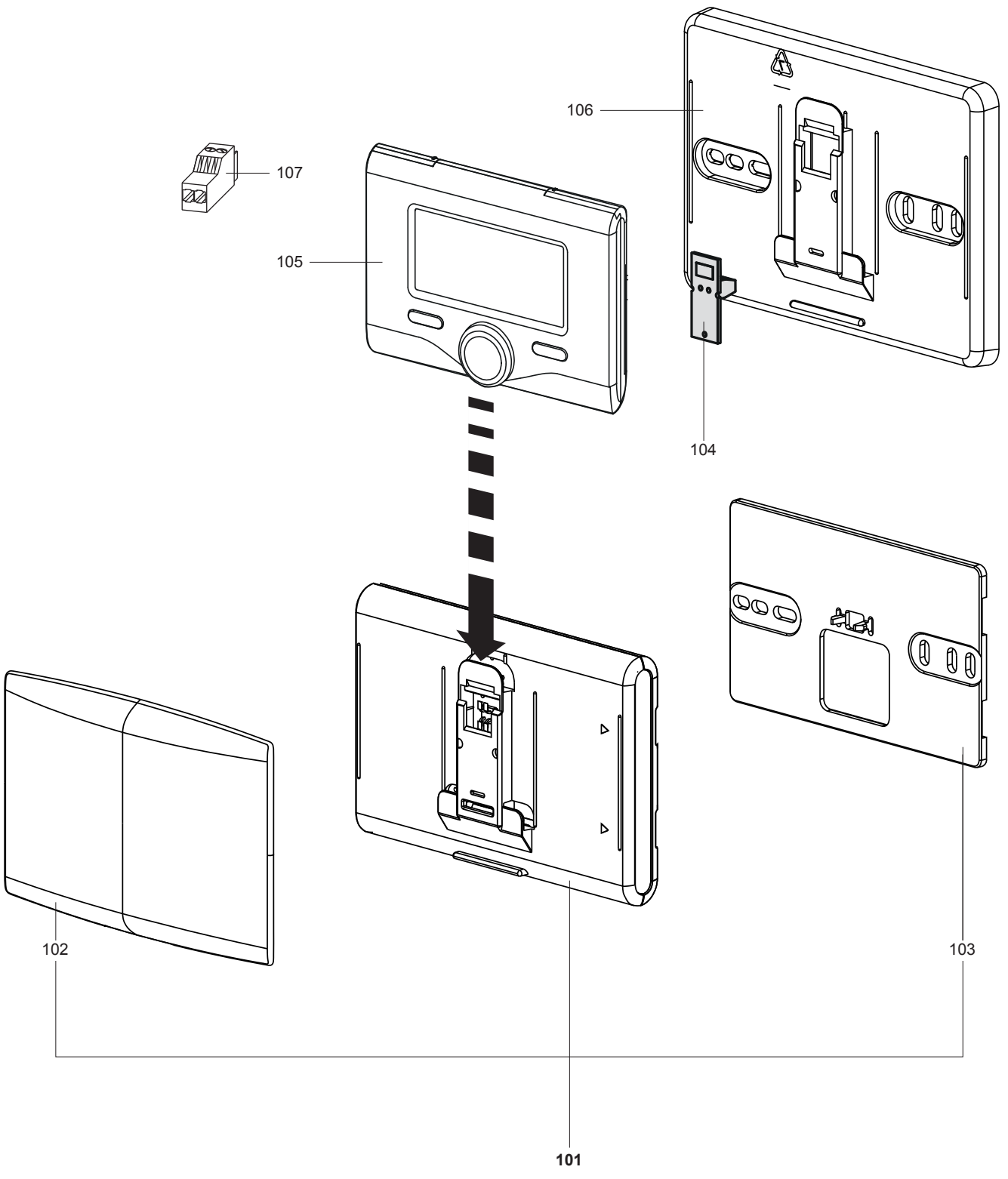

SPARE PARTS EXPLODED VIEW
ACCESSORIES FOR CONTROLLERS
Model
LIGHT GATEWAY

R8217582-02 - 30/01/2018

1	3319089	ARISTON NET LIGHT GATEWAY	10-2016	-
2	3319090	CHAFFOLINK LIGHT GATEWAY	10-2016	-
3	3318991	ARISTON NET LIGHT GATEWAY + SENSYS	07-2016	-
4	3318992	CHAFFOLINK LIGHT GATEWAY +EXPERT CONTROL	07-2016	-
5	3319034	ARISTON NET LIGHT GATEWAY + SENSYS (CN)	07-2016	-
Col	Reference	Model type	Begin	End





Description

Manf. Pt. N

Type

3318889
3318990
3318991
3318992
3319034

31

1 2 3 4 5 6 7 8 9 10 11 12 13 14 15 16 17 18 From to

			1	2	3	4	5	6	7	8	9	10	11	12	13	14	15	16	17	18	From	to
0101	ARISTON NET LIGHT GATEWAY	3319089-SP	●	●																		
	CHAFFOLINK LIGHT GATEWAY	3319090-SP		●		●																
	CHAFFOLINK LIGHT GATEWAY+EXPERT CONTR	3319034-SP					●															
0102	COVER (AR)	65116083	●	●	●																	
	COVER (CM)	65116086		●	●	●																
0103	WALL PLATE	65116082	●	●	●	●	●															
0104	P.C.B. CONNECTOR	65112042			●	●	●															
0105	SYSTEM INTERFACE	65112083-05			●	●																
	SYSTEM INTERFACE	65116085-01					●															
0106	WALL PLATE	65112824			●	●	●															
0107	CONNECTOR 2P	65111933			●	●	●															

LIGHT GATEWAY

Accessories for controllers

LIST OF THE ABBREVIATIONS

HW	: Hot water.
CW	: Cold water.
C	: Ceramic resistance (normal heating).
Ca	: Ceramic resistance (accelerated heating)
TP	: Immersion heater.
1F	: With fittings.
2F	: Without fittings.
3F	: With fittings and another outlet connection.
AMI	: With mixing valve.
SMI	: Without mixing valve.
PUISS	: Power of th appliance.
PN	: Appliance with normal pression.
LP	: Appliance with low pression.
PV	: Appliance with variable power.
PF	: Appliance with fixed power.

The indications mentioned on the prices, commercial or technical literature and the scheme are written for your guidance and are available at a given time. The CONSTRUCTOR retains the power to modify the presentation, the form, the size, or the conception or the material of the products.
